

SMR

MODULAR SHOULDER REPLACEMENT

 **Lima Corporate**
Orthopaedic 

BALANCED *by design*

- + *Evolved*
MODULARITY
- + *Reliable*
FIXATION
- + *Proven*
PERFORMANCE

Over 20 Years Of Clinical Evidence

Over 200.000 Implants Worldwide

ODEP 10A Rating SMR Reverse*

ODEP 10A Rating SMR Anatomic**



* Uncemented / Metal Glenosphere / Polyethylene Liner Combination.
** Cemented Glenoid / Uncemented Humeral Stem.
Latest ODEP Ratings can be found at www.odep.org.uk

SMR

MODULAR SHOULDER REPLACEMENT

BALANCED

by design



EVOLVED MODULARITY

The SMR System has been designed to offer to surgeons the possibility to choose the most appropriate solution according to the patient's clinical case, with the aim of improving stability and restoring the shoulder Range-Of-Motion.^[1-4]

GLENOID LATERALIZATION

With built-in offset & connectors.

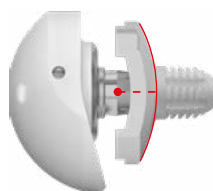

	MB Size	Regular (mm)	+2 Connector (mm)	+4 Connector (mm)
36mm	Small-R	5.1	7.1	9.1
	Small/STD	5.4	7.4	9.4
HP 40mm	Small-R	5.5	7.6	9.6
	Small/STD	5.9	7.9	9.9
HP 44mm	Small-R	5	7	
	Small/STD	5.4	7.4	

HUMERAL LATERALIZATION

With lateralizing reverse liners.



150 deg.



140 deg.



40mm and 44mm
+4mm LATERALIZING
reverse liner CoCr

The 140 body increases humeral offset by 2mm

PROVEN PERFORMANCES

SMR Reverse* was the **first reverse replacement** to be ranked as an **ODEP 10A** Rating. 10A is awarded to implants that have demonstrated at least 90% SURVIVAL AT 10 YEARS based on data meeting ODEP criteria.

The SMR system is proudly the **only shoulder system** to achieve a **benchmark** on the Australian Orthopaedic Association National Joint Replacement Registry for both Total Stemmed Anatomic Shoulder Replacement and Primary Total Stemmed Reverse Shoulder Replacement at 10 years.^[9]



[Bibliography](#)



RELIABLE FIXATION

SMR can provide different fixation strategies – cement, press-fit, TT bone ingrowth – both on humerus and on glenoid side.^[5-8]



B.1304.83.01C.1

022400